

XHXX-GZB地块用地红线图

2620.807-39465.841

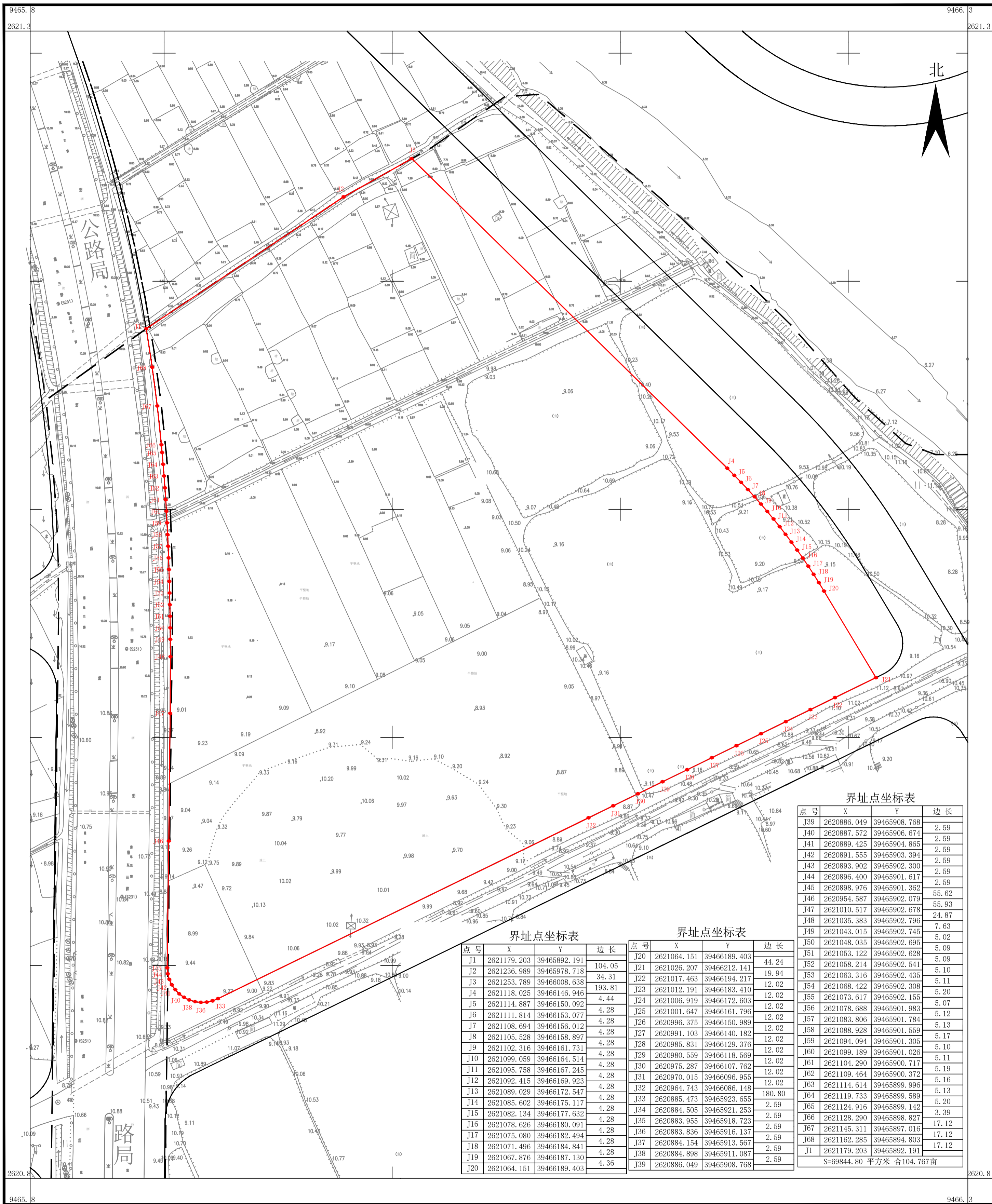

界址点坐标表

点号	X	Y	边长
J39	2620886.049	39465908.768	2.59
J40	2620887.572	39465906.674	2.59
J41	2620889.425	39465904.865	2.59
J42	2620891.555	39465903.394	2.59
J43	2620893.902	39465902.300	2.59
J44	2620896.400	39465901.617	2.59
J45	2620898.976	39465901.362	55.62
J46	2620954.587	39465902.079	55.93
J47	2621010.517	39465902.678	24.87
J48	2621035.383	39465902.796	7.63
J49	2621043.015	39465902.745	5.02
J50	2621048.035	39465902.695	5.09
J51	2621053.122	39465902.628	5.09
J52	2621058.214	39465902.541	5.10
J53	2621063.316	39465902.435	5.11
J54	2621068.422	39465902.308	5.20
J55	2621073.617	39465902.155	5.07
J56	2621078.688	39465901.983	5.12
J57	2621083.806	39465901.784	5.13
J58	2621088.928	39465901.559	5.17
J59	2621094.094	39465901.305	5.10
J60	2621099.189	39465901.026	5.11
J61	2621104.290	39465900.717	5.19
J62	2621109.464	39465900.372	5.16
J63	2621114.614	39465899.996	5.13
J64	2621119.733	39465899.589	5.20
J65	2621124.916	39465899.142	3.39
J66	2621128.290	39465898.827	17.12
J67	2621145.311	39465897.016	17.12
J68	2621162.285	39465894.803	17.12
J1	2621179.203	39465892.191	104.05

界址点坐标表

点号	X	Y	边长
J1	2621179.203	39465892.191	104.05
J2	2621236.989	39465978.718	34.31
J3	2621253.789	39466008.638	193.81
J4	2621118.025	39466146.946	4.44
J5	2621114.887	39466150.092	4.28
J6	2621111.814	39466153.077	4.28
J7	2621108.694	39466156.012	4.28
J8	2621105.528	39466158.897	4.28
J9	2621102.316	39466161.731	4.28
J10	2621099.059	39466164.514	4.28
J11	2621095.758	39466167.245	4.28
J12	2621092.415	39466169.923	4.28
J13	2621089.029	39466172.547	4.28
J14	2621085.602	39466175.117	4.28
J15	2621082.134	39466177.632	4.28
J16	2621078.626	39466180.091	4.28
J17	2621075.080	39466182.494	4.28
J18	2621071.496	39466184.841	4.28
J19	2621067.876	39466187.130	4.36
J20	2621064.151	39466189.403	44.24

界址点坐标表

点号	X	Y	边长
J20	2621064.151	39466189.403	44.24
J21	2621026.207	39466212.141	19.94
J22	2621017.463	39466194.217	12.02
J23	2621012.191	39466183.410	12.02
J24	2621006.919	39466172.603	12.02
J25	2621001.647	39466161.796	12.02
J26	2620996.375	39466150.989	12.02
J27	2620991.103	39466140.182	12.02
J28	2620985.831	39466129.376	12.02
J29	2620980.559	39466118.569	12.02
J30	2620975.287	39466107.762	12.02
J31	2620970.015	39466096.955	12.02
J32	2620964.743	39466086.148	180.80
J33	2620959.471	39465923.655	2.59
J34	2620954.200	39465912.848	2.59
J35	2620948.928	39465902.041	2.59
J36	2620943.656	39465891.234	2.59
J37	2620938.384	39465880.427	2.59
J38	2620933.112	39465869.620	2.59
J39	2620927.840	39465858.813	2.59

S=69844.80 平方米 合104.767亩

潮州市佳图测绘工程有限公司

2000国家大地坐标系
1985国家高程基准
1996年版图式

1:1000

测量员: 林旭钦 洪锐彬
绘图员: 林旭钦
检查员: 郑楷淳